

Intelligent toilet

C21260W-P-07

ZTT-501

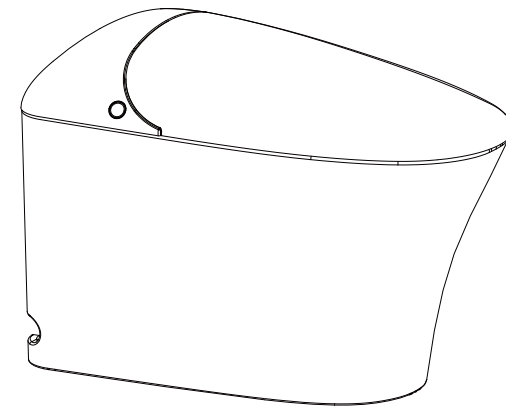

- Attention: Do NOT use storm water or tank water in this product.
- Please read these instruction carefully before beginning installation. Please keep it in a safe place.
- Attention: Installation shall be in accordance with the AS/NZ 3500 series of Standards.
- Working Water Pressure 150-500Kpa.

Table of contents

Before use

Safety precautions	3
Precautions for use	6
Correct use	7
Function introduction	8
Product parts	9
Remote control	10
Preparation and confirmation before use ..	11

How to use

How to use the product	13
How to adjust the temperature	14
Function adjustment and use	15
Flushing method	16

Cleaning & Maintenance

Cleaning method	17
Daily cleaning method	17
Other cleaning methods	19

Fault diagnosis & Maintenance

Fault diagnosis & Maintenance	20
Technical data	23

Installation instructions

Installation Manual	24
---------------------------	----

Safety precautions





Please Read Carefully

This product is a Class I appliance. Please observe the following precautions for your safety.

! BUYER READING The remote control for the machine is a full-function remote control. Depending on the model you bought, some functions of the remote control may not be available for the machine.

- ※ In order to prevent the danger accidentally resetting the fuse, the fuse of the product is closed.
- ※ Do not use any fuses that do not meet the product specifications.

Meaning of symbols

	Warning	Indicates that improper handling of the product may cause death or serious injury to the user.
	Caution	Indicates that improper handling of the product may cause injury or physical damage to the user.
	Dismantling prohibited	It means forbidden. The left figure means "Dismantling prohibited".
	Must be obeyed	Must not be dismantled or self repaired and modified. May cause fire or electric shock.

 Dismantling prohibited Must not be dismantled or self repaired and modified. May cause fire or electric shock.

 Caution

This product is an electronic product, please do not install the product in splashed or damp places.

When installed in a bathroom equipped with a bathtub and a toilet, please install an exhaust device such as an exhaust fan to keep the air flowing to avoid fire or electric shock.

Keep the power plug away from the bathtub as far as possible and place it 1 meter or more away from the bath to avoid potential fire or electric shock.

Please use 220-240V~ power supply, otherwise may cause fire or electric shock.

This product is equipped with a grounding wire. The power plug must be plugged in properly and grounded.

When installed in a bathroom equipped with a bathtub and a toilet please seal the plug with bathroom silicone at the contact points to prevent water or moisture from penetrating to avoid fire or electric shock.

Please ensure the install area is waterproofed.

 No watering Do not spray water onto the main body or power supply. May cause fire or electric shock.

Prohibit

Do not use faulty products.
Please pull out the power and turn off the water valve to stop the water supply under the following conditions.

- The main body or water pipe leaks
- The product is cracked or broken
- Abnormal noise or smell
- The product start to smoke

The use of faulty products is prohibited, otherwise it may cause fire or electric shock.



Prohibit

Do not use water sources other than tap water or potable water, otherwise it may cause inflammation of the skin.

Do not use loose or shaking power outlets, otherwise it may cause fire or electric shock.

Do not exceed the specifications of the power supply or outlet, please use 220-240V~ power supply.

Multi-outlet sockets are easily over-loaded and may cause fire due to heat generation.

Do not use excessive force on the power plug or damage it.
No modification.
Do not force, twist or pull on the power cord.
Do not place heavy items on it.

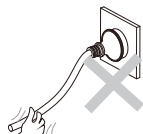

Caution



Must be obeyed

No flammable are to be used near this products as it this may cause fire or electric shock.
Cigarettes and other burning materials cannot be thrown into the toilet.



No wet hand touch

Do not use wet hands to plug and unplug power as this may cause fire or electric shock.



Prohibit

Do not step on the seat, seat cover or body of the toilet.
Do not place heavy items on the product as it may damage the product and cause injury, it may also I cause water seepage in the room.
Do not obstruct or unplug air outlet, otherwise it may cause burns or electric shock.
Do not bend or flatten the connecting hose. Otherwise it may cause water leakage, the water pressure may be reduced or that maybe no water.
Clean with mild detergent.
Tighten the water pipe when connecting, or it may cause water seepage.
Do not split the water pipe with the water valve open, otherwise it may splash water.
Do not discard any debris other than excrement and toilet paper in the toilet bowl.

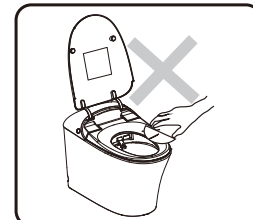

Must be obeyed

Tighten the water filter during installation.
Otherwise it may cause water leakage.
Turn off the water valve if it is leaking.

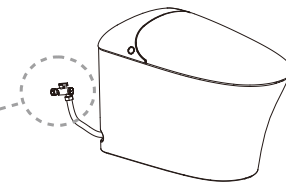
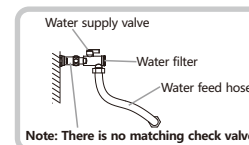

Room temperature is not to be lower than 5 degrees Celsius as the drainpipe or toilet seat may be damaged, which will cause water leakage or fault if water freezes.

Precautions for use

Please follow the warnings below.

Please wipe the main body, seat and cover with a soft cloth.

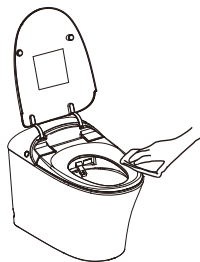

Avoid splashing into the main body or spout, it may cause fault.

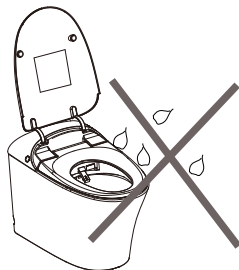

Please disconnect the power when not in use for a long time.

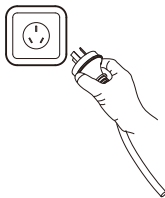

Please use products such as radios at a distance from the product as it may influence to the radio signal.

Please don't install the product in a direct sun light.

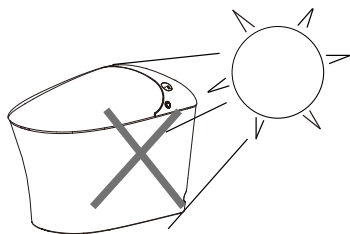

Do not block the touch sensor area and the remote sensor area as this may result in touch sensor and remote control failure.

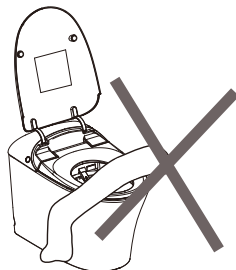

Turn off the main power supply during thunderstorms.



Do not lean on the seat cover when using, which may cause defect or damage.

Correct use

Use power-saving function
When the power-saving function is set, the seat temperature is maintained at about 25°C. When a person is seated, the power-saving function is automatically turned off and normal temperature control is in action.

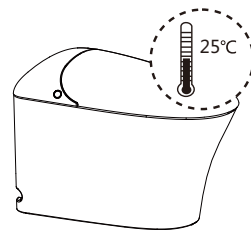

If unable to use the remote control, press the button on the toilet seat.

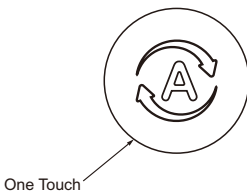

How to use in winter
In order to prevent freezing in winter, please follow the following methods to manage.
1. Check whether the power plug is properly inserted into the socket.
2. When the bathroom has no heating device, please use cloth to wrap connecting pipes or other insulating materials for insulation.
3. In winter or long term disuse, close the inlet water valve, cut off the inlet water source. With on hand press the seat sensor and press "One Touch Function" to empty the inlet water. Than unplug the power to turn off.

Please close the seat cover
It can prevent the heat from the seat from escaping outwards and saving electricity by closing the seat cover.

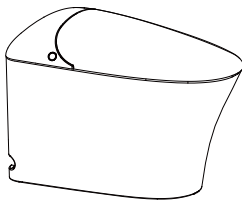

! Must be obeyed

Please use tap water for water supply. Do not use other water sources other than tap water that do not meet hygienic standards. This can cause inflammation of the cleaning area or equipment failure.

Function introduction

Classification	Function	Specification
Basic function	Rear wash	Clean the buttocks.
	Front wash	Clean the female genitals.
	Warm seat	The seat temperature is adjustable.
	The seating detection	The system is equipped with human body induction sensor, and only after the detection of human body sitting, can the function of cleaning or drying be carried out.
	Warm air drying	Dry the buttocks with warm air.
	One touch	One key automatically completes buttocks cleaning, flush and warm air drying.
Auxiliary function	Defecation clean	A column of clean water is pumped into the end of the anus to help defecation.
	Cold and hot SPA	Cold and hot water alternately washes the anus or perineum.
	Menstrual deep care	Clean the female genitals with customized parameter for female menstruation.
	Fragrance	Adjust aromatherapy concentration.
	Sensor zone	Refers to a range of about 1 meter in front of the toilet.
	Seat Sensor	When leaving the seat: ① If the cover is closed, when there is no object entering sensor zone after holding for 10 seconds. If there is any object enters the microwave induction region, it will automatically open the cover. ② When leaving the seat, if there is no object entering microwave induction region after holding for 5 minute. It will automatically close the cover. If the seat is opening, it will close the seat and cover.
Convenient function	Cleaning position adjust	Adjust the cleaning position.
	Water temperature adjust	Adjusts the water temperature.
	Seat temperature adjust	Adjusts the seat temperature.
	Air temperature adjust	Adjusts the air temperature.
	Water pressure adjust	Adjust water volume and water pressure.
Comfort function	Soft lighting	LED soft lighting.
	Air-mix water cleaning	Bidet wand will mix air and water for soft cleaning.
	Automatic deodorization	Keep the air fresh in bathroom.
	Energy saving mode	Power saving while no usage.
Security function	Anti-electricity leakage	Electricity leakage protection to avoid case.
	Heat monitor	Temperature safety device to avoid high temperature of the air and water which may cause injury.
	Self-checking	Reminder in abnormal circumstances.
Cleaning function	Nozzle cleaning	When not seated, stick out the spray rod for daily cleaning.
	Swing cleaning	Swing the spout of front & back for cleaning.
Flushing mode	Auto flush	Flushing automatically after people leave the seat cover.
	Flush by controller	Flushing water by controller.
	Manual flush	This button can be used if the remote control is out of batteries.
	Foot sensor flush	When leaving the seat, put your foot for more than 1 second in the foot sensing area, then it will flush 1 time automatically. When seated it can't flush automatically.

Product parts

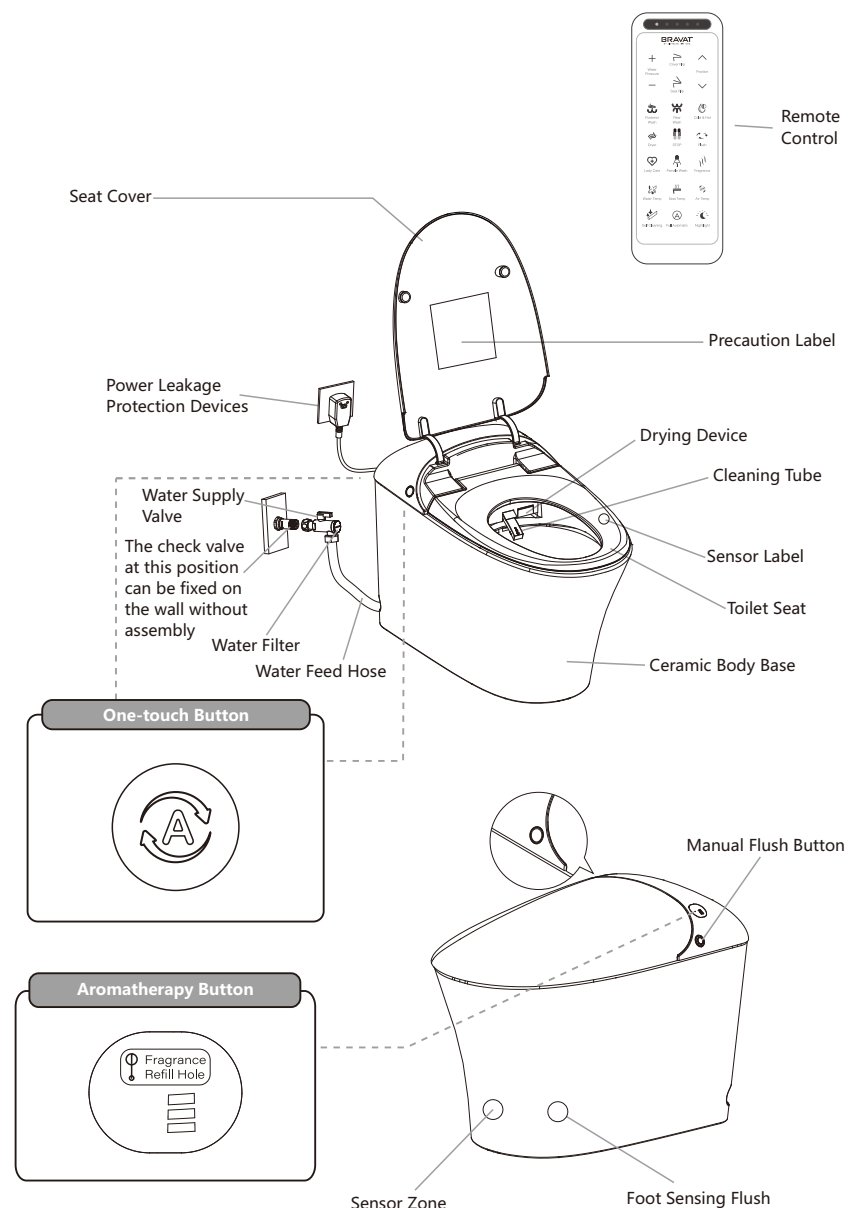

Remote control

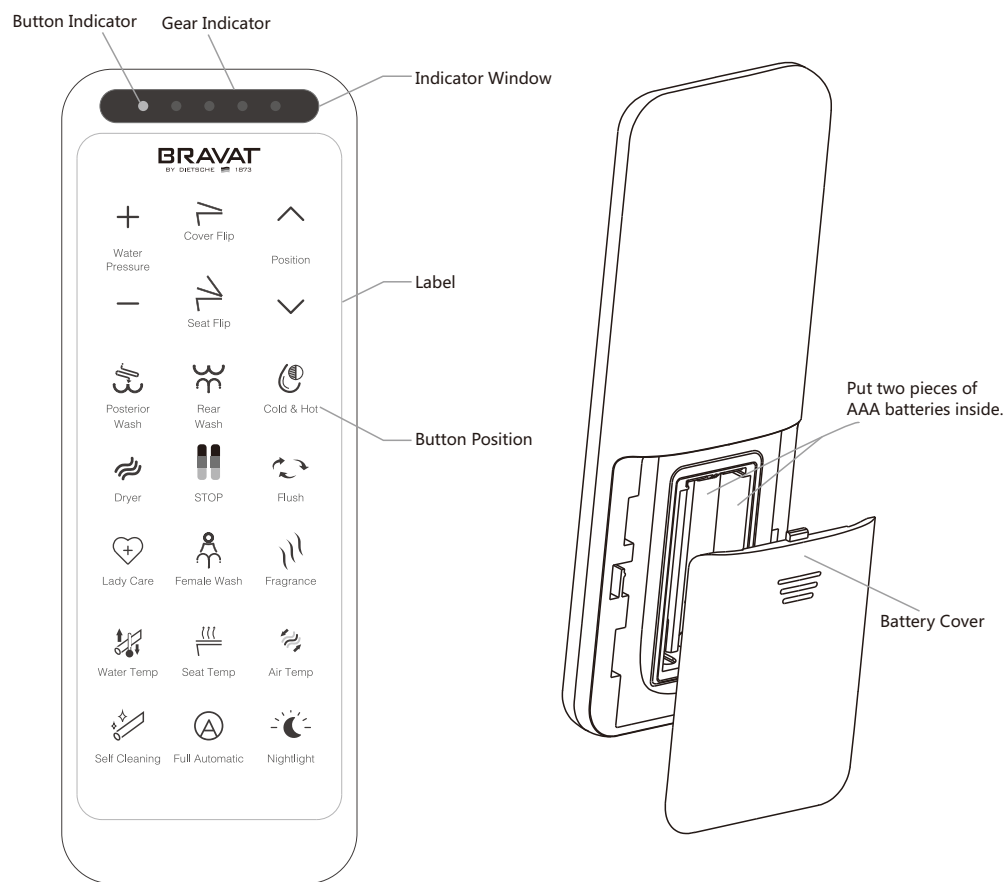

Remote control code matching steps:

1. Simultaneously press "Nozzle Cleaning" and "Stop/Power" button, Wait for 2 seconds, until gear indicator 4 lights are all turned on and flashing.
2. After code matching, the third and fourth lights of the gear indicator are on, which means code matching is successful. Then press any button on the remote control to return to normal performance. If not successful, after 15 seconds, the toilet will return to previous state.

Preparation and confirmation before use

Preparation

1 Remote control installation steps

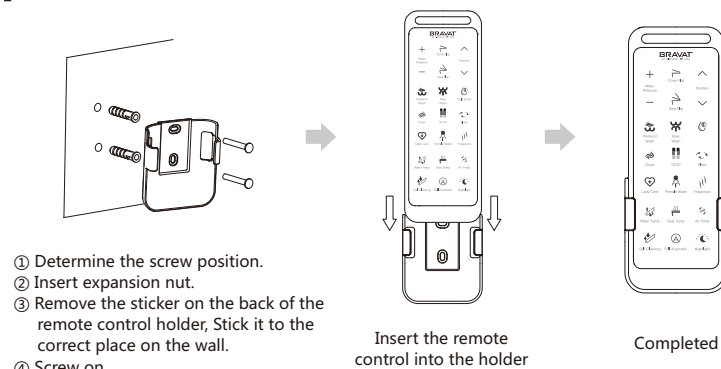

About batteries

- To prevent the battery from breaking or leaking liquid, please observe the following.
 - Use two same type batteries.
 - Take out the batteries when it is not used for a long time.
 - Do not use rechargeable batteries.
- The current settings (temperature, power saving, automatic flushing) may be lost after battery replacement. Please reset it.

2 Make sure the power plug is plugged in

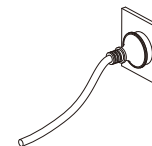

Advice 1

Turn off the power of the main operation area when replacing the battery or repairing.

Preparation and confirmation before use

3 Turn on the water supply valve

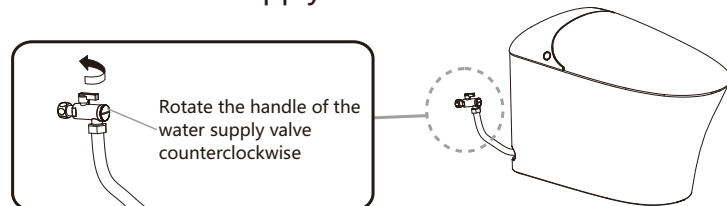

Confirmation

4 Confirmation of main body display panel

To check if the power indicator of the main body display panel is on.

Please check if the light of the main body display panel is on.

Check if the power is connected.

If not, please turn on the remote control and confirm the relevant function button.

5 Fragrance Purification Precautions

<p>Step 1:</p> <p>Child keyhole</p> <p>Insert the child's keyhole with a paper clip or a SIM card picker needle. At the same time, press the fragrance purification cover, it will automatically pop out.</p>	<p>Step 2:</p> <p>Take out the cover.</p>	<p>Step 3:</p> <p>Take out both outer and inner covers.</p>	<p>Step 4:</p> <p>Tighten the fragrance essential oil bottle counterclockwise into the cover.</p>	<p>Step 5:</p> <p>Put the components into the corresponding positions, and then insert the needle or paper clip into the hole, and press the cover to complete the installation.</p>
----------------------------------------------------------------------------------------------------------------------------------------------------------------------------------------------------------------------	--------------------------------------------------	--------------------------------------------------------------------	----------------------------------------------------------------------------------------------------------	---------------------------------------------------------------------------------------------------------------------------------------------------------------------------------------------

How to use the product

For the first time, programming the machine.

- ① Check if water pressure is greater than 0.15 Mpa.
- ② Only use tap water. Do not use seawater and stormwater.
- ③ Ensure the machine waterway is completely connected to the tap water without leakage.
- ④ Use the manual flush key to check the connection status of the machine waterway and the machine flush status. After confirmation, go to the next step.

1 Check the power

Insert the plug into a power point.

2 Human body sensing (Figure 1)

Only in the seated state, cleaning function and drying function can be used.

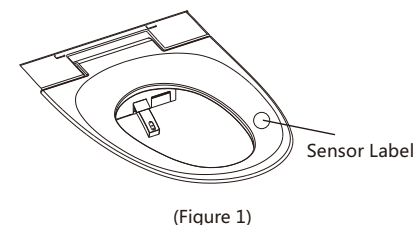

3 Discharge the air inside the machine (Figure 2)

When using it for the first time, please touch the sensor label area with your hand, or place a wet tissue on the sensor label area. Smooth out the toilet bag on the seat lid and press the rear wash button, so that the toilet enters the cleaning mode.



4 Check the cleaning function

In the seated state, press the rear wash, front wash and other washing functions. During washing, check the water temperature, water pressure and nozzle position adjustment is correct.

5 Check the drying function

In seated state, enter the drying function, during the drying process, check the air temperature adjustments is correct.

6 Check deodorant function

In the seated state, check whether the deodorizing fan works.

7 Check the flushing function

Press the manual flush button, to check if the flushing reaches of the toilet's edge and bottom, when water is splashing, the edge flushing component is adjustable.

How to use the product

Shortcut



Short press: start wash buttocks.
Long press: start / stop mobile wash.



Female Wash

Short press: start female wash.
Long press: start / stop mobile wash.



Dryer

Short press: start warm air drying.



STOP

While off the seat, touch and hold the remote control stop/power button for 3s or more to enter standby mode.

In standby mode, press the stop/power button to exit standby mode.

In the cleaning mode, press the stop/power button to exit the cleaning mode.

Way's to adjust temperature

- Seat temperature and water temperature can be adjusted by remote control. Please select the appropriate temperature.

1 Take out the remote control

2 Adjust the temperature



Adjust water pressure



Short press "+" , water pressure grade +1, short press "-" , water pressure grade -1.



Adjust tube front and rear position.



Short press "^" , tube position grade +1, short press "v" , tube position grade -1.



Adjust seat temperature

Seat Temp

Short press: cyclically adjust seat temperature.



Adjust water temperature

Water Temp

Short press: cyclically adjust water temperature.



Adjust air temperature

Air Temp

Short press: cyclically adjust air drying temperature.

Auxiliary functions



Full Automatic

One-touch completes rear wash and warm air drying.
Short press: start automatic "One Touch" mode.

Function adjustment and use



Posterior Wash

Bidet nozzle sprays strong water pressure for deep cleaning.
Short press: start defecation clean.



Fragrance

Adjust aromatherapy concentration.
Long press can adjust the concentration.



Cold & Hot

Cold & Hot SPA: water alternately massages and washes.
Short press: start cold & hot massage. Press continuously: turns SPA on or off.



Lady Care

Cleaning the genitals with customized parameters during woman's menstrual period.
Short press: start menstrual care wash. Press continuously: turns Lady Care on or off.



Nozzle Cleaning

When not seated, stick out the nozzle for daily cleaning.
Short press: start nozzle cleaning.



Nightlight

Night light during night
Short press: turn night light on or off. Press continuously: enter or exit energy saving mode.



Flush

Toilet flush
Short press: toilet flush, can not flushing during wash processing.



Seat Flip

Seat Flip
Short press to open or close the seat.



Cover Flip

Cover Flip
Short press to open or close the seat cover.

Others

Light sensor

- 1 minute after manually turning on the night light, the light sensor is automatically turned on, and then according to ambient brightness automatically adjusts the night light on or off.
- Manually turn off the night light, the light sensor is off.

Energy saving

After the user leaves the seat it intelligently adjusts the heating power of the seat.

Intelligent Memory

The Smart toilet can remember the last time the user used the cleaning function and repeats those settings.

- In the power saving mode, the water and seat temperature may be lower than the set temperature.

Flushing method

There are four types of flushing methods: auto flush, manual flush, remote flush, and foot sensor flush.

Remote control flushing method



Triggered foot sensor signal

Foot induction flush

- Keep your foot near the foot sensor area for more than 1 second.
- When leaving the seat, hold your foot for more than 1 second in the foot sensing area, then the toilet will flush 1 time automatically. When seated it can't flush automatically.

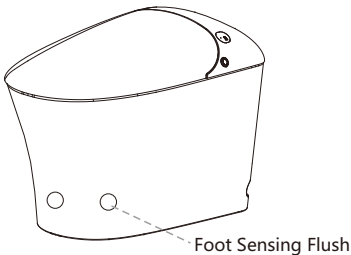

Flush the toilet without electricity

- The flushing function can still be achieved by processing the manual flush button.

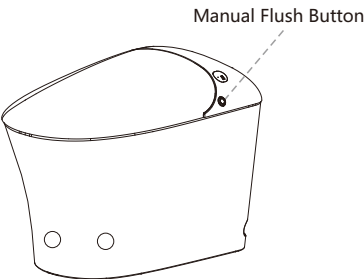

Cleaning methods

Daily cleaning methods

◆ Cleaning the main body、toilet、cover

- Use a wet soft cloth
 - Use a soft cloth dampened in water and wipe gently.
- When it is dirty
 - Wipe with diluted PH (neutral) cleaner with soft cloth.
 - Clean up with water.
- When stained with toilet water
 - clean the toilet water with a soft cloth dampened with water and wipe off the remaining water.

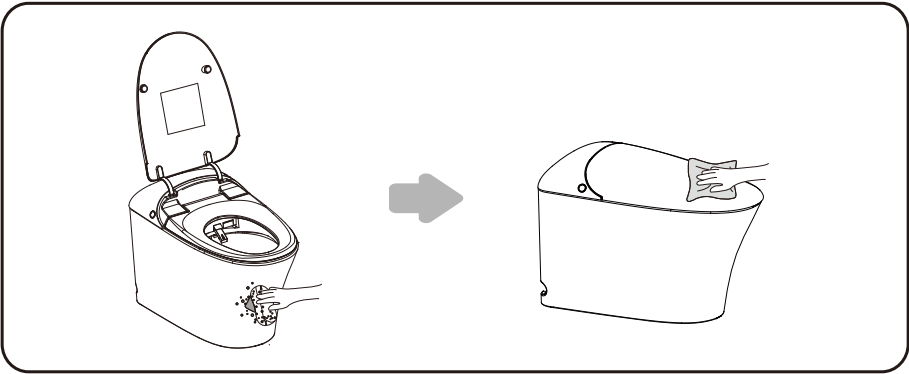

- Advice 1**
 - It is an electronic product, please pay attention to prevent the product from entering the water.
- Advice 2**
 - Dirty sensing area may cause the cleaning operations to malfunction.

Cleaning methods

◆ Nozzle cleaning

- No water spray when the nozzle extend making it easy to clean.

1 Extend nozzle

Extend the nozzle and press the nozzle cleaning button on the remote control.

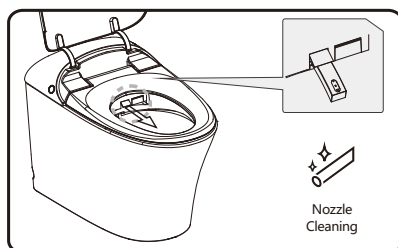

Nozzle Cleaning

2 Cleaning

Please use a soft brush to clean, do not pull or push the nozzle, it may cause damage or fault.

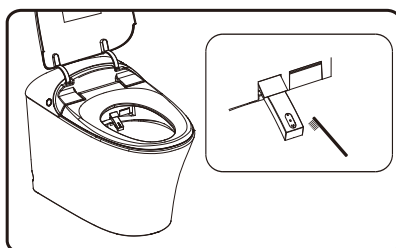

3 Cleaning

Advice 1

Clean the stains on the nozzle.



4 Set the nozzle back

Press the  button

Seat on

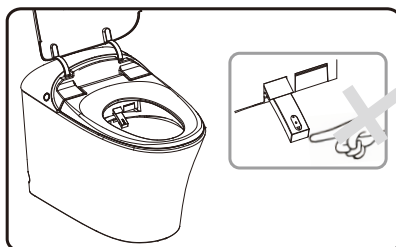

Advice 1

- Do not push the nozzle, it may cause damage or fault.
- Do not use any detergent, clean with water. Do not use too much force it may deform the nozzle.

Other cleaning methods

◆ Clean up the filter screen

- When the water supply valve is closed, cut off the machine water supply, do the following operation.

1 Close the water valve and stop the water supply

Rotate the handle of the water supply valve clockwise.



⚠ Caution



When the water valve is not closed, do not open the filter.

2 Disassemble the filter screen

Use a coin or a screwdriver to turn right to loosen the filter screen.

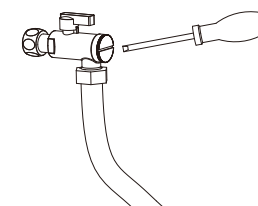

3 Cleaning

- Open the filter screen and clean the dirt on the filter screen.
- Use a toothbrush and other utensils to clean the sediment.
- Clean the sediment inside the water valve with a rag.

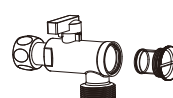

Advice 1

4 Re-install the filter screen

Use a coin or a screwdriver to turn left to tighten the filter screen.

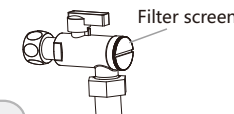

⚠ Caution



- The filter must be tightened when installed.
- It will cause water leakage if it is not tightened.

5 Open the water supply valve

Rotate the handle of the water supply valve anticlockwise. Check whether the water leaks.



Advice 1

- Clean the filter
- Do not use detergents, clean with water.
- Do not use too much force when cleaning, it may deform the filter.

Fault judgment and maintenance

Please read the following items before taking measures if it is identified as a fault. Please contact with the place of purchase, specialty shop or the company's customer service center if you cannot solve the problem.

Unplug the power cord before fixing.

⚠ Caution

! Must abide by

※ When the cable is damaged, the manufacturer, after-sales service center or licensed trades person is responsible for replacement to avoid a safety incident. Please use a new water tube, do not use the used water tube. Close the valve first to stop the water supply if water leaks.

Turn the shut off valve clockwise.

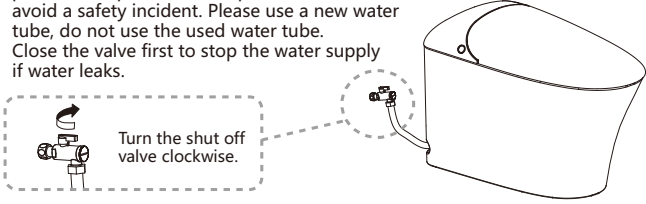

Please confirm the following items before requesting maintenance.

Confirm the power

Fault	Potential Cause	Solution
Function not working	Check all the power cord, power point or main power.	Make sure all the power is working.

Cleaning, special cleaning, defecation clean

Fault	Potential Cause	Solution
No cleaning water	Is the water supply stopped? Is the water valve closed? Is the sensor in the correct position?	Wait for water, please open the water valve Refer to page 9 of the seat sensor position.
Cleaning water pressure weakened	Is the water pressure set too weak? Is the filter clogged?	Please adjust the water potential power by "button description" on the remote control. Please change or clean the filter.
The water temperature is too low	Is the warm water switch turned off or set the temperature too low? Is it in a power saving state?	Please reset the water temperature by "button description" on the remote control. The water temperature will remain at 28°C, during the power-saving state and may be lower than the setting temperature. When seated, the power saving state will be released and the temperature will rise to the original temperature setting.
Spray stops cleaning after 1 minute	This is a factory setting. Not a fault.	press button again.

Fault judgment and maintenance

Fault	Potential Cause	Solution
Water stops during cleaning. When seated, the spray sprinkles water inside the toilet for a few seconds.	Is the human body touching the contact sensor. After sensing by the sensor, in order to provide warm water, the sprinkler emerges, this is not malfunction	Please confirm seat and the sensor position of page 9.

Sensor

Fault	Potential Cause	Solution
When seated, it will start cleaning or deodorizing function.	Is the seat wet or soiled?	Clean and dry the seat.

Toilet seat

Fault	Potential Cause	Solution
The heated seat is not heating.	Is the seat's heating strength set in the low or off state? Is the toilet set in the energy-saving state? Is there a power outage?	Reset the seat temperature by "button description" on the remote control. Press the power button to exit energy-saving state. Wait for power recovery.

Power saving function

Fault	Potential Cause	Solution
Power-saving function does not work.	Is the power cord unplugged or the batteries on the remote control expired?	Press the energy saving button on the remote control, Reset. 

Remote control

Fault	Potential Cause	Solution
Remote control failure.	Are the batteries out of power? Are the batteries installed correctly? Is the remote sensor head blocked? Is the remote sensor head dirty with dust or watermark? Has the human body touched the correct sensor?	Replace the batteries. Please install the batteries correctly. Move away the obstruction. Clean up dust or watermarks. Confirmation of Seat ring and contact sensor location on Page 9.

Fault judgment and maintenance

Confirm the power no cleaning water

Fault	Potential Cause	Solution
Deodorization function does not work.	Has human body touched the contact sensor?	Confirm the position of the sensor on the seat.

Air drying

Fault	Potential Cause	Solution
The air temperature is not high enough.	Is the air temperature set to a low level?	Reset the air temperature by "button description" on the remote control.
Drying stops halfway.	After pressing the  button 3 minutes the function stops automatically. The sensor might be turned off and the drying function be stopped because of movement of the human body in sitting position.	Press the button again. Confirm the position of the seat and the sensor.
The dryer doesn't work.	Has the human body touched the sensor?	

Others

Fault	Potential Cause	Solution
Washing process stops halfway	Is the water valve open fully? Is the water valve filter blocked? Is the pressure of the water supply too low when sharing water with the toilet?	Fully open the water valve. Change or clean the filter. —
No washing water.	Is the water valve closed? Is the water stopped?	Turn on the water valve completely. Wait for water.
When leaks occur at the contact area of the supply hose.	Is the nut at the contact part loose?	Tighten the nut with tools.







Technical data

Model		C21260W-P-07 / ZTT-501
Rated voltage		220-240V~
Rated frequency		50Hz
Rated power		1300W (15°C±1°C inlet water temperature)
Length of wire		1.5m
Water supply mode		Directly connected to the channel
Temperature of surroundings		About 3°C to 40°C
Temperature of supply water		About 3°C to 35°C
Water pressure range		0.15MPa-0.8MPa
Water resistance		IPX4
Safety devices		Seated sensor, water over-pressure protection device
Decontaminating apparatus	Heating method	Instant heating
	Warm water temperature	Four grades (Room temperature to 40°C)
	Spray volume	Buttock cleaning About 0.5 to 0.8L/min
		Women-only About 0.5 to 0.8L/min
	Warm water heater	1600W
Drying device	Safety device	Temperature sensor, temperature fuse, temperature safety switch
	Wind speed	> 4m/s
	Air temperature	Four grades(Room temperature to 59°C)
	Drying heater	200W
Deodorizing device	Safety devices	Double-sheet-metal switch, temperature fuse, temperature sensor
	Deodorant	Activated carbon
	Power consumption	1.5W
Thermal seat	Seat temperature	Room temperature to about 40°C
	Seat heater	45W
	Safety devices	Temperature Sensor , temperature fuse
	Switch structure	Damping slowdown
Size		686mm*395mm*499mm
Weight		35.6KG

Notes: When water pressure is less than 0.15MPa, it is recommended to install booster pump. Otherwise it may affect your normal use.

Installation Manual

1 Safety precautions

	Warning	Indicates that the improper use of the product may result in death or serious injury to the user.
	Caution	Indicates that improper use of the product may result in injury to the user or material damage.
	Dismantling prohibited	Prohibition of splitting or transforming the main body.
	Must be obeyed	Indicates that it must be obeyed, the left figure indicates strict compliance.
<hr/>		
	Caution	
	Prohibit	Do not step on the seat, cover, body, impact, or place heavy objects. It may cause injury or water leakage.
	Must be obeyed	Use specified accessories when installing.

2 Matters needing attention in installation environment

① Installation space

While ensuring the space required for installation, please confirm whether the door opening affects the installation of the product.

-The distance between the water supply pipe and the ground should be more than 150mm.

Please confirm water supply position and the position of PVC pipe before installation.

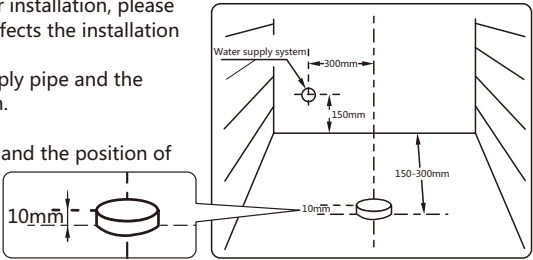

② Installation space

Minimum water pressure: 0.15Mpa, If this pressure is less than 0.15Mpa, the product cannot flush effectively.

Key Points of Minimum Hydraulic Pressure Testing

The water pressure can be tested by the method shown on the right if there is no water pressure test device.

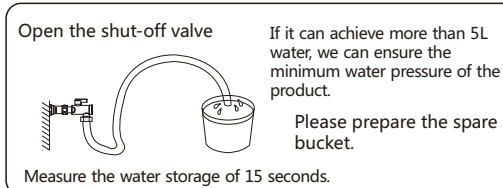

③ Drawing for installation

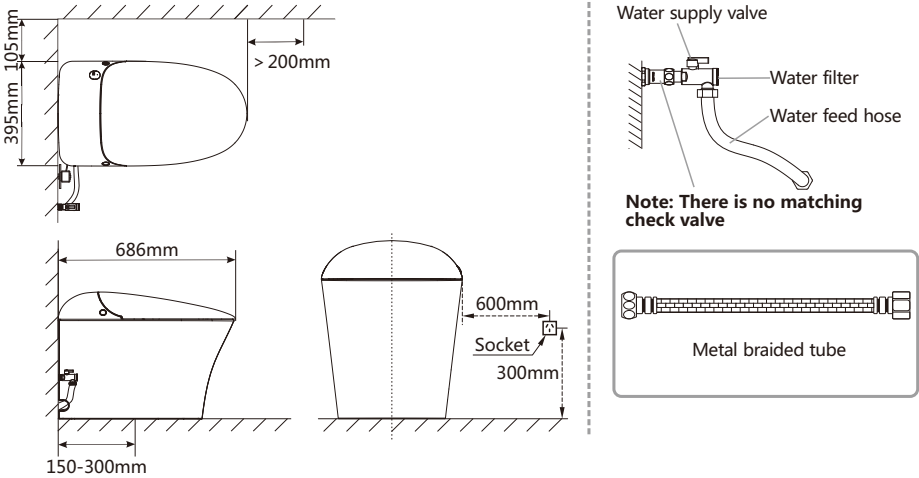

Accessories

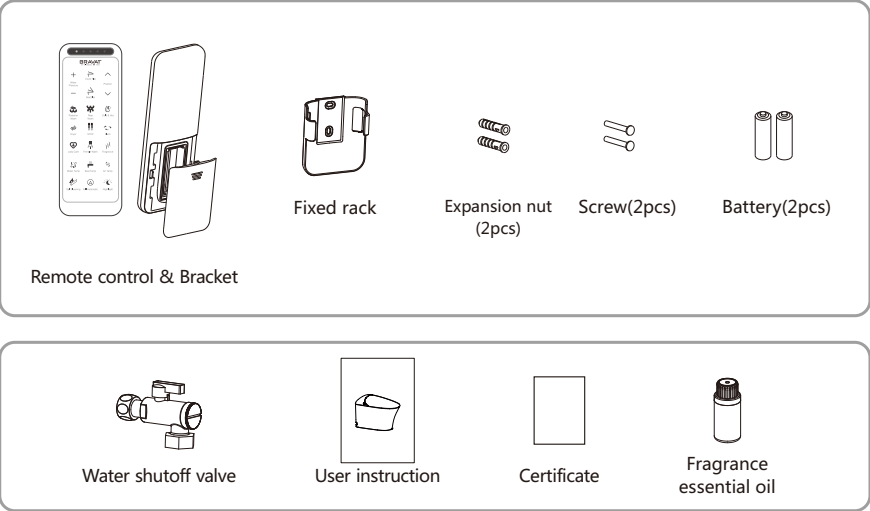

3 Installation

① Install the shutoff valve

1. Close the valve.
2. Please flush the water supply pipe before installation of the shutoff valve.
3. Use waterproof tape to tie the shutoff valve and the water outlet pipe.
4. The water inlet pipe with one-way valve is connected with the water supply valve.
5. Tighten carefully. Install the filter connection carefully (may cause water leakage.)

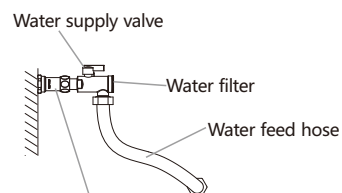

Note: There is no matching check valve

② Connect hose

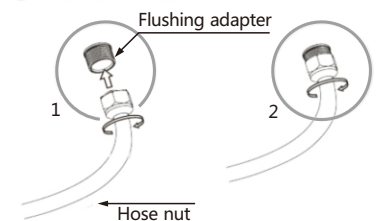

1. Connect the inlet hose to the water inlet.
2. Turn inlet hose screw clockwise and tighten it up.

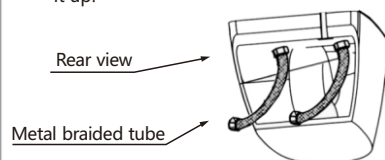

Use the new water pipe along with the product and do not to use the old water pipe.

③ Install the shifters and toilets

1. Adjust or cut off the pipe according to rough in distance.
2. Glue the cut into place.
3. Put the A into proper clip location as the picture, Complete the connection between the screw pole and the wall.

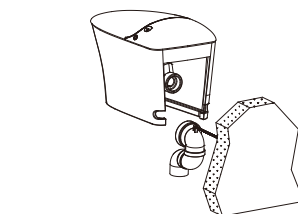

4. Move the W.C Bowl to the wall slowly as picture in order to connect to the waste bend pipe without any leaking.

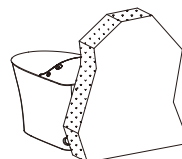

5. As the picture, test-water after completing the installation to check whether water leaks out from the bottom of the W.C bowl or not. Finally attach the bottom of the W.C bowl and the floor with silicone sealant.

④ Bracket installation

1. According to the illustration, select the appropriate position, drill the hole with the hand drill first, and then drive the expansion tube into the wall.
2. Align the hole of the remote control bracket with the expansion tube, screw the screw into the expansion tube and fix there mote control bracket.
3. Insert the remote control into the bracket. (The remote control is preferably fixed in a place where ventilation is convenient to use. It is best not to take out the battery in the remote control if it is not use for a long time.)

Note: The remote control bracket can also be directly fixed to the wall. With Sponge double-sided tape.

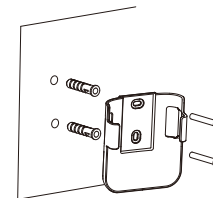

⑤ Connect power

1. Connect the plug to a power outlet.
2. Press the flush button on the remote control-the pan will be filled with water.



In areas with high water pressure, it may splash water or overflow when flushing, so turn the water supply valve clockwise to decrease the water pressure.

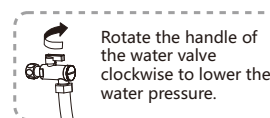

Rotate the handle of the water valve clockwise to lower the water pressure.

